

Kwikset

INTERCONNECT WITH KEY CONTROL DEADBOLT



A SMART SOLUTION FOR MULTIFAMILY HOUSING

- Meets fire code rating for emergency panic exit
- ANSI/BHMA Graded
- Meets 3 hour UL rating
- Lever options are in compliance with the American National Standards Institute (ANSI A117.1) and the Americans with Disabilities Act (ADA).
- Fits standard door prep – 5 1/2" center to center
- Easy installation
- Features SmartKey Security™ – Re-Key in Seconds



THE #1 SELLING U.S. LOCK BRAND*

*Source: TraQline US quarterly brand unit share report, Q4 2006 through Q3 2017

81896-12/17

Kwikset

INTERCONNECT SPECIFICATIONS

Door Prep	Crossbore 2-1/8", Edge Bore 1", 5-1/2" center-to-center only.
Backset	Complete locksets: 2-3/4" UL or 2-3/8" UL.
Door Thickness	1-3/4" and 2-1/4".
Cylinder	508 SMT - utilize 816 deadbolt with SmartKey Security™.
Faceplates	Complete locksets: No default - must specify faceplate. 1" round corner, 1" square corner, 1-1/8 WFL square. Complete locksets: UL 3028, 3031 (WFL option 3846).
Strikes	Deadbolt Strike: UL 5278, 3223 (WFL 4632 opt.).
Door Handing	506, 508, 505, 507 - reversible 502, 502 - specify handing.
ANSI/BHMA	508
ADA	Lever options are in compliance with the American National Standards Institute (ANSI A117.1) and the Americans with Disabilities Act (ADA).
UL	Meets 3 hour fire rating for all functions.

KEY CONTROL DEADBOLT SPECIFICATIONS

Standard Door Prep	Crossbore 2-1/8", Edge Bore 1", Latch Face 1" x 2-1/4".
Door Thickness	1-3/4" or 1-3/8" (with adaptor kit).
Cylinder	2 SmartKey Security™ cylinders: 1 standard Kwikset for users, 1 unique patented keyway for 1-Key Control.
Faceplate	1" x 2-1/4".
Strike	1-1/4" x 3-5/8".
Bolt	1" throw.
ANSI/BHMA	Grade 2 Certified.
ADA	Interior tn piece meets 4.13.9 ADA.
UL	Meets 3 hour fire rating for 817 UL Optional 1/3 hour UL fire rating for all functions.

INTERCONNECT DIMENSIONS

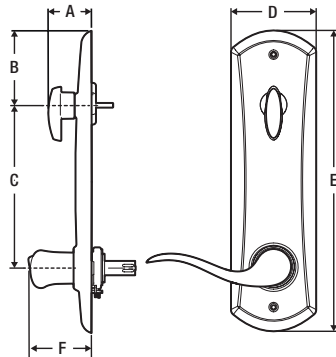

Design	A	B	C	D	E	F
Interconnect	1 7/16"	2 15/32"	5 1/2"	2 53/64"	10"	2 31/32"



HOW TO RE-KEY YOUR LOCK IN SECONDS



Make sure you have your current key and SmartKey tool.



Current Key



SmartKey Tool



New Key

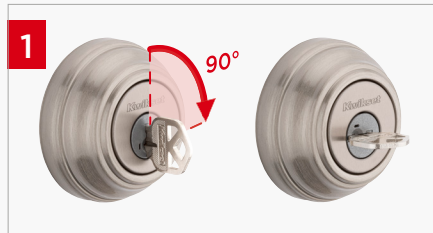

Insert the key that currently operates your lock, and rotate it 90° clockwise.

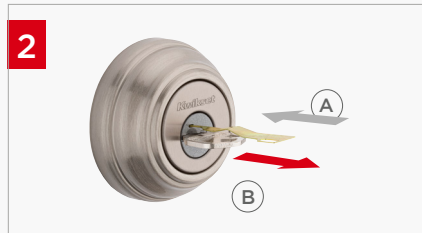

(A) Insert the SmartKey tool fully and firmly into the SmartKey hole. (B) Remove the SmartKey tool and the current key.

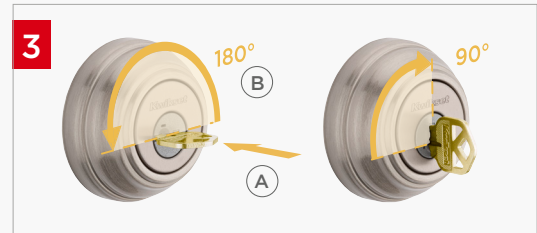

(A) Fully insert your new key into the lock, and rotate it 180°. (B) Rotate the new key 90° back to the starting position, and remove it. Your lock is now re-keyed to your new key, and your old key will no longer operate the lock.

DEADBOLT DIMENSIONS

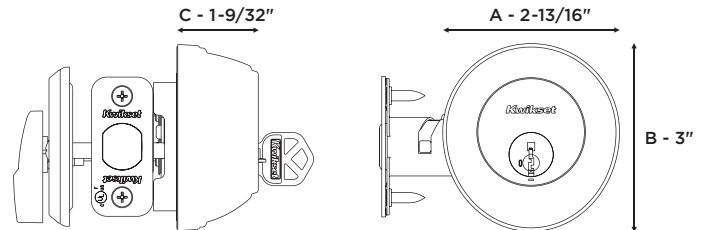

FINISHES



L03/3
Polished
Brass



11P
Venetian
Bronze



15
Satin
Nickel



26D
Satin
Chrome